

2383 Jefferson Avenue,
West Vancouver, B.C.

Main Floor: 1,355 sq.ft.
Upper Floor: 955 sq.ft.

Total: 2,310 sq.ft.

Crawl Space: 1,355 sq.ft.
Open to Below: 36 sq.ft.

Auxiliary Area

Garage: 416 sq.ft.

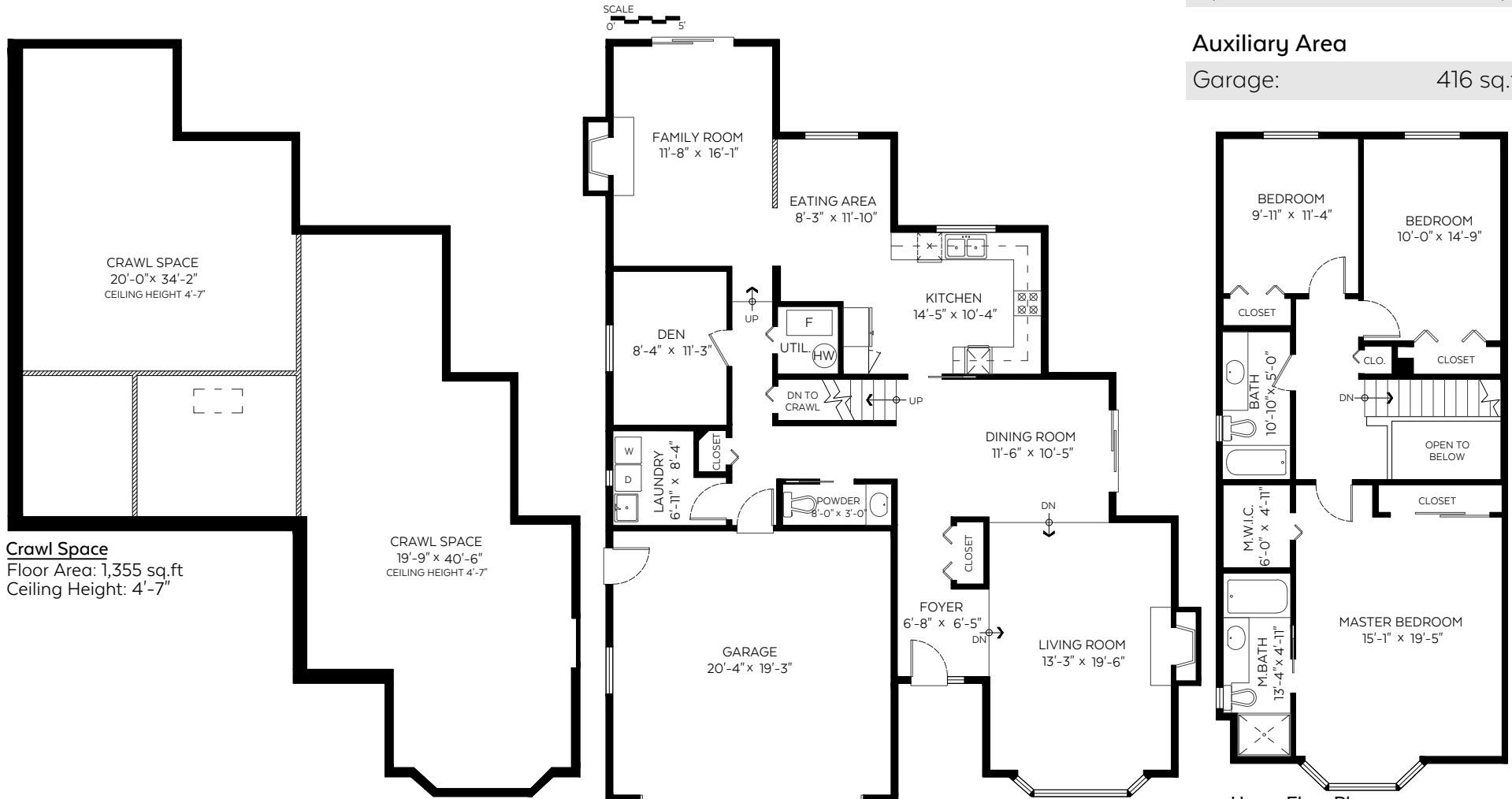

Crawl Space
Floor Area: 1,355 sq.ft
Ceiling Height: 4'-7"

CRAWL SPACE
19'-9" x 40'-6"
CEILING HEIGHT 4'-7"

Main Floor Plan
Floor Area: 1,355 sq.ft
Ceiling Height: 8'-7"

Upper Floor Plan
Floor Area: 955 sq.ft.
Ceiling Height: 8'

Measured on: Feb. 16, 2018

The floor plan is not suitable for architectural/construction and is covered under E&O. © Excelsior Measuring Inc. 2018. All rights reserved for Excelsior Measuring Inc. Users shall not publish and distribute such material (in whole or in part) and/or incorporate it in other works in any form.



NORTH

