

BRIAN RHYS

PERSONAL REAL ESTATE CORPORATION

c778.829.1105

brian@brianrhys.com

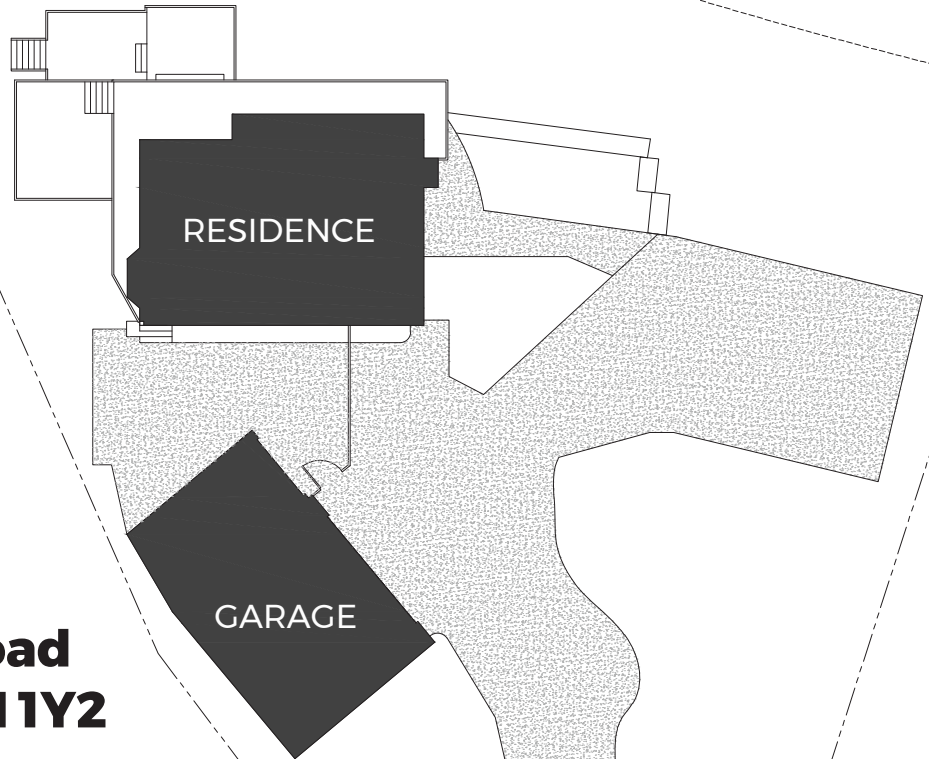

10054 Wescan Road Halfmoon Bay V0N 1Y2

ABOVE MAIN	675	SQFT
MAIN FLOOR	1,130	SQFT
BELOW MAIN	1,112	SQFT
TOTAL AREA	2,917	SQFT

DETACHED GARAGE*	704	SQFT
WORKSHOP*	302	SQFT
TOTAL DECK SPACE*	1,211	SQFT

west coast
MEASURING
604.492.4959

©2019 West Coast Measuring. For marketing use only. Not for construction or architectural purposes. Area calculations based on ANSI Z765 - 2003 Method For Calculating Square Footage using interior measurements. Variance is +/- 2%. While deemed correct, this plan is not guaranteed. NOT A LEGAL SURVEY (* Not Included in Total Area) E&O insured

