

MAIN LEVEL
Floor Area: 597 Sq. Ft.

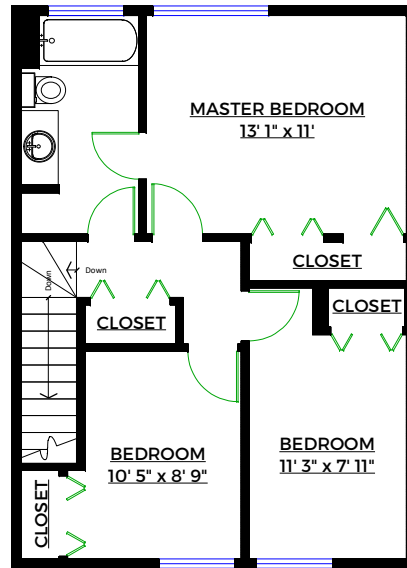

UPPER LEVEL
Floor Area: 573 Sq. Ft.



**#60 - 3030 Trethewey Street,
Abbotsford, B.C.**

Totals**

Main Level:	597 sq. ft.
Upper Level:	573 sq. ft.
Total (FIN):	1,170 sq. ft.
Storage:	21 sq. ft.
Grand Total:	1,191 sq. ft.

Porch:	24 sq. ft.
Carport:	408 sq. ft.
Storage:	36 sq. ft.
Yard:	266 sq. ft.
Total:	734 sq. ft.

**Approx. based on interior measurements to exterior walls
**Total square footage not taken from original blueprints

