



BROCK SMEATON

— PERSONAL REAL ESTATE CORPORATION —



4831 WATER LANE

Olde Caulfeild | West Vancouver

ENTRANCE

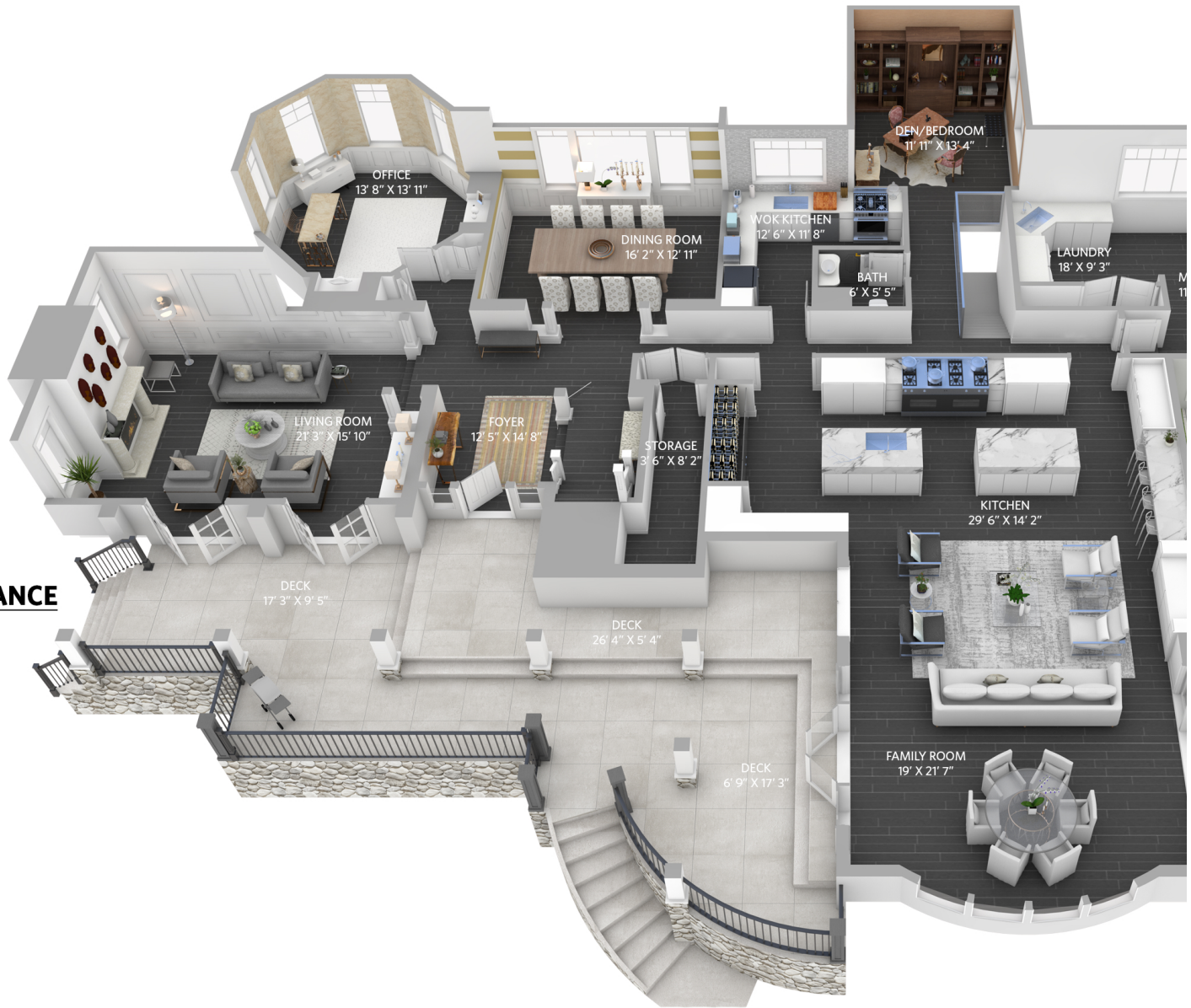

Main Floor - 3,018 sq.ft.

Ceiling height - 8' 8" to 17' 10"



MAGNIFICENT ESTATE HOME IN OLDE CAULFEILD

Magnificent estate home in Olde Caulfeild on a completely private double lot (over 35,000 sq. ft.). Originally designed by Lamoureux Architects, this house was completely remodeled with over 2100 sq. ft. added in 2017/2018. Features include 7300 sq. ft. of total luxury on 3 levels, including an amazing family room, stunning kitchen that features the most beautiful La Cornue stove, large formal living, dining rooms, and 2 separate offices. Upstairs features a gorgeous master suite with incredible dressing room, as well as 4 more large ensuite bedrooms. Downstairs offers a wonderful media room plus guest bedroom and bathroom. This park-like property offers incredible landscape and gardens by Paul Sangha, 2 separate gated driveways and garage parking for 5 cars, plus a finished cave with sound room and tons of storage, and a beautiful sundrenched pool and spa. The house is fully air conditioned and has a complete Crestron home automation system. Don't miss this one.

SPECIFICATIONS

Bedrooms:	6
Bathrooms:	7
Full Baths:	6
Half Baths:	1
Living Area:	7,296 sqft
Lot:	35,241 sqft
Taxes:	\$23,325.98





Upper Floor - 2,895 sq.ft.
Ceiling height - 8' 0"

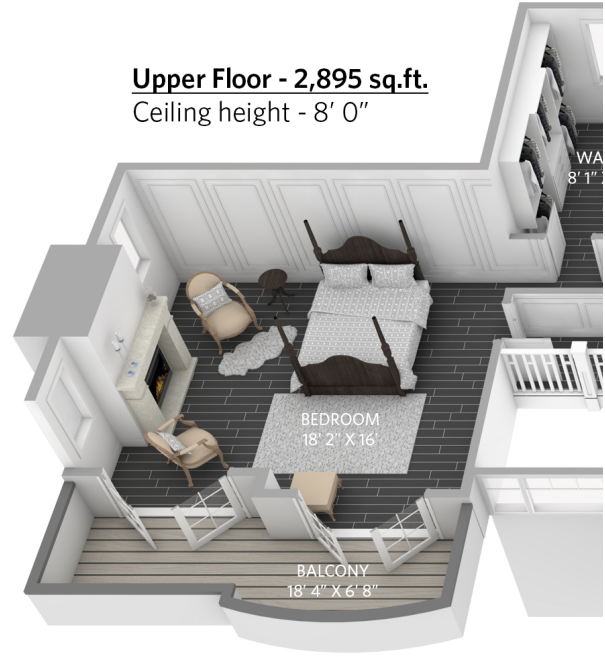



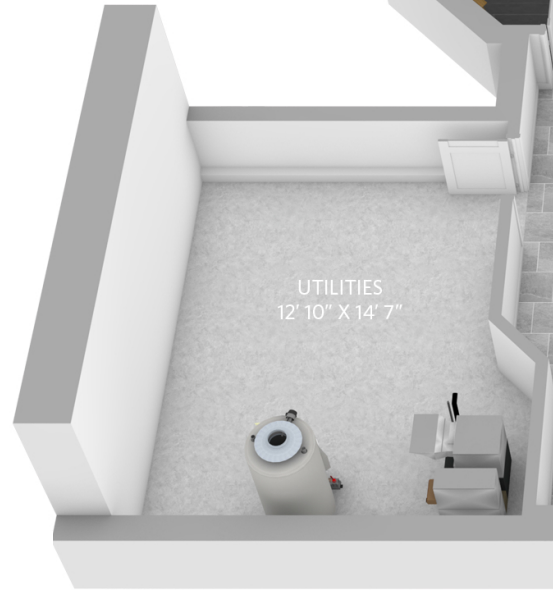

Lower Floor - 1,383 sq.ft.
 Ceiling height - 8' 9"

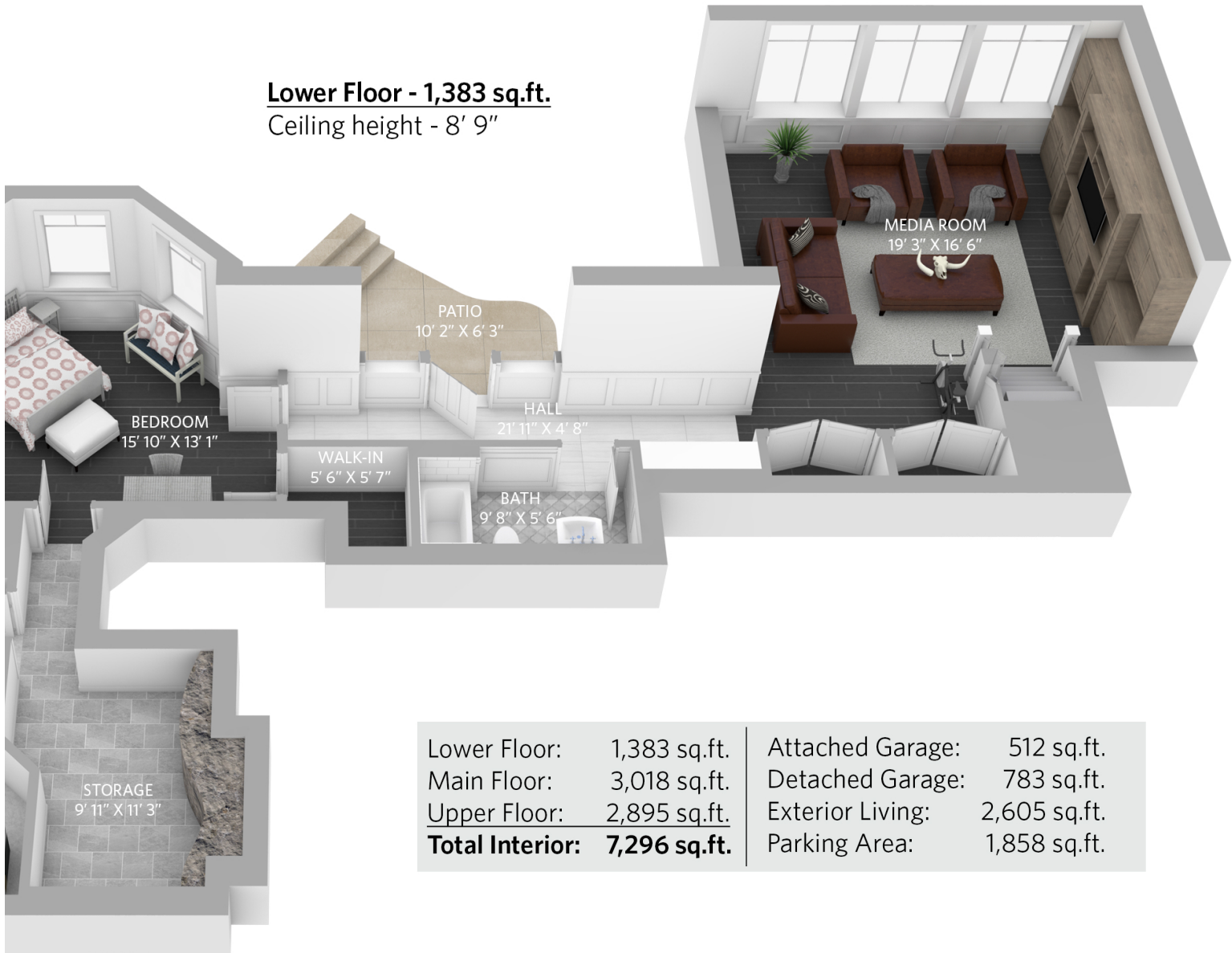

Lower Floor:	1,383 sq.ft.	Attached Garage:	512 sq.ft.
Main Floor:	3,018 sq.ft.	Detached Garage:	783 sq.ft.
Upper Floor:	2,895 sq.ft.	Exterior Living:	2,605 sq.ft.
Total Interior:	7,296 sq.ft.	Parking Area:	1,858 sq.ft.





C 604.619.9131 O 604.925.2911
W www.brocksmeaton.com E brock@brocksmeaton.com

ROYAL LEPAGE | **Sussex**

2397 Marine Drive West Vancouver, BC V7V 1K9