



12 - 2250 Bellevue Avenue, West Vancouver, B.C.

Totals**

Main Level: 3,150 sq. ft.

Deck: 134 sq. ft.

Primary Deck: 39 sq. ft.

Bedroom Deck: 27 sq. ft.

Total: 200 sq. ft.

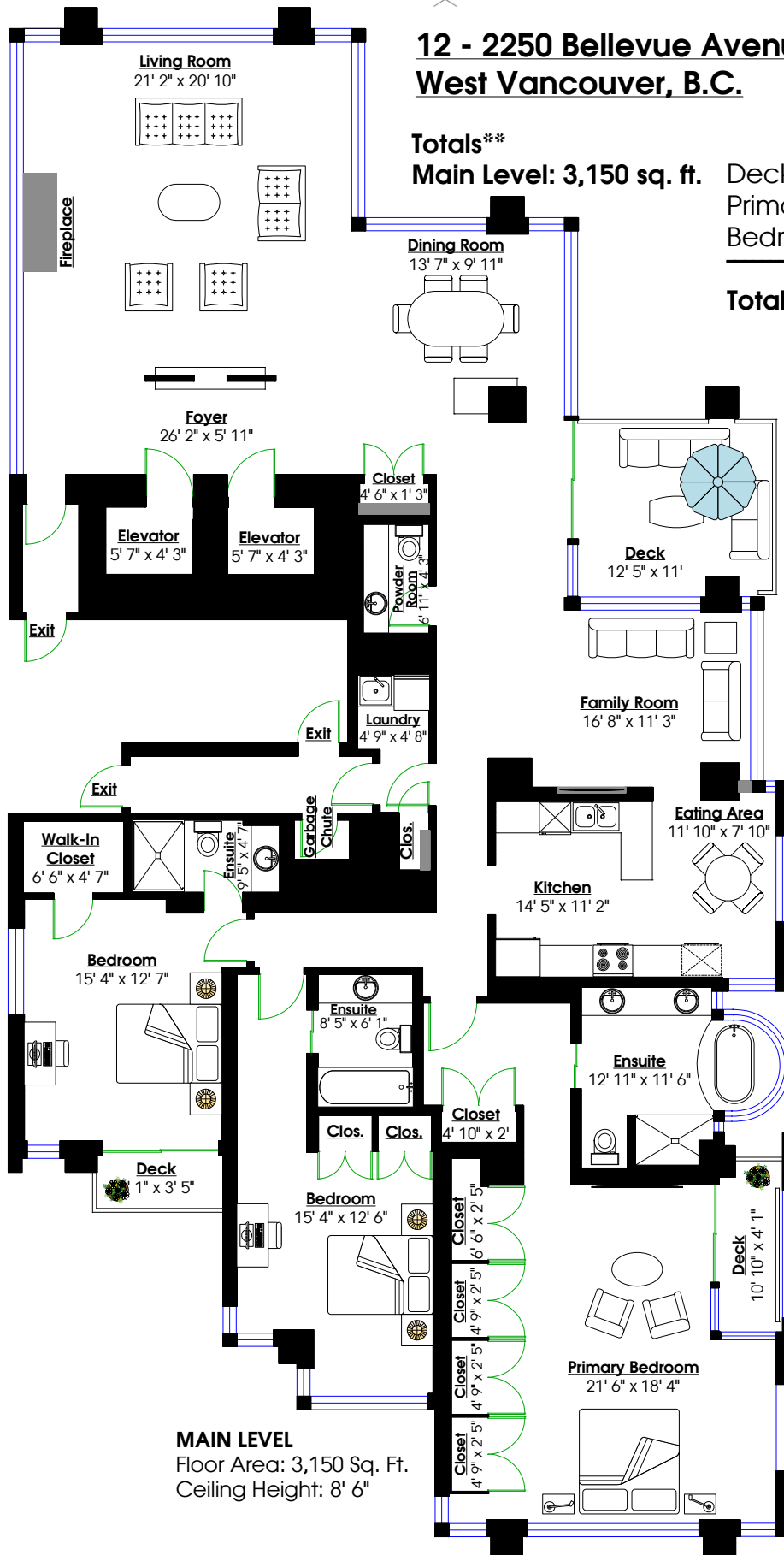

MAIN LEVEL
Floor Area: 3,150 Sq. Ft.
Ceiling Height: 8' 6"

