

# 5054 Forrest Dr, Yellowknife, NT

Main Floor Total Exterior Area 1509 sq ft  
Total Interior Area 1402 sq ft

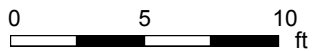

PREPARED: Jul, 2020



White regions are excluded from total floor area. All room dimensions and floor areas must be considered approximate and are subject to independent verification. For method of measurement please see <https://youriguide.com/measure/>.

# 5054 Forrest Dr, Yellowknife, NT

Workshop Total Exterior Area 41 sq ft

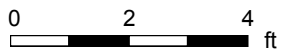
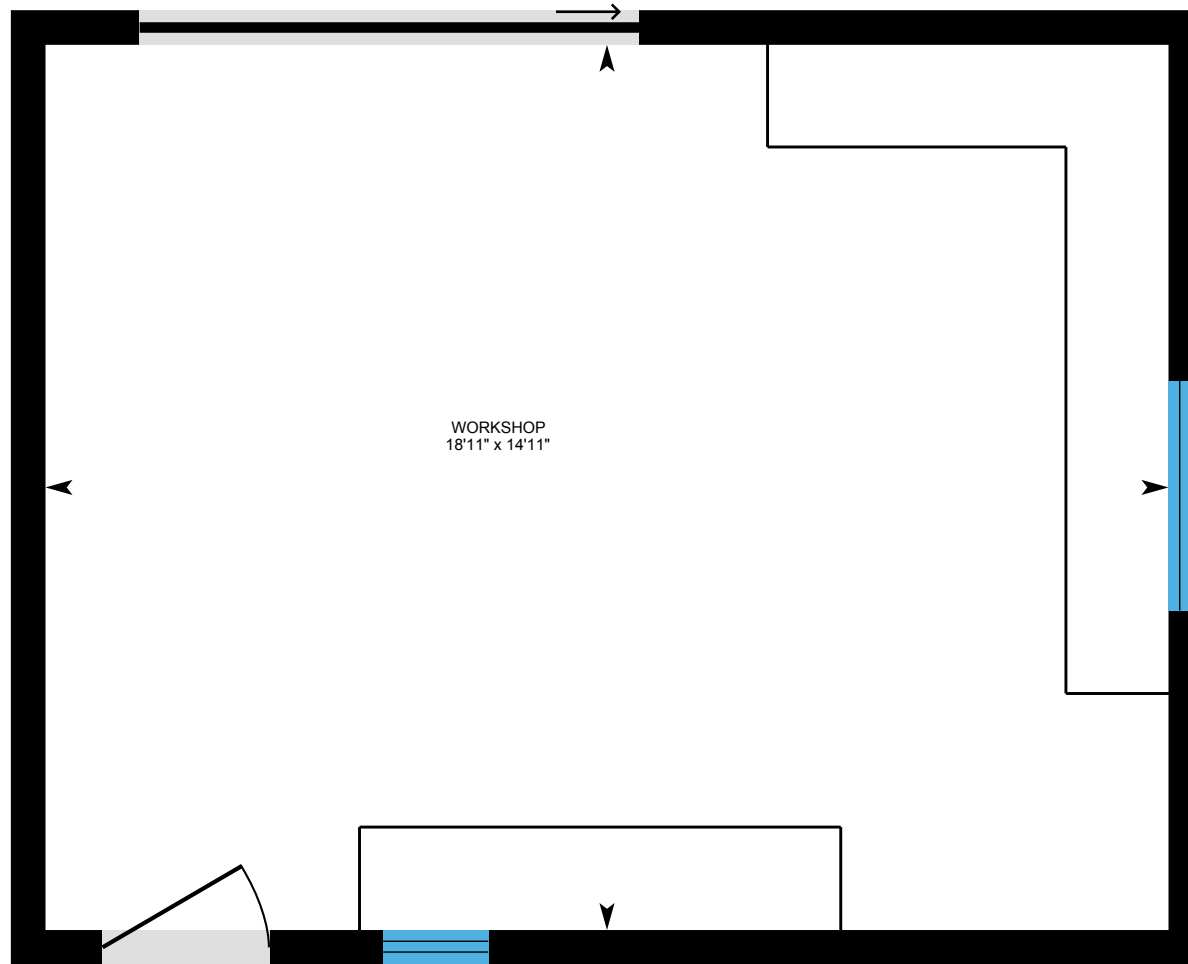

PREPARED: Jul, 2020



# 5054 Forrest Dr, Yellowknife, NT

## Property Details

### Room Measurements

Only major rooms are listed. Some listed rooms may be excluded from total interior floor area (e.g. garage). Room dimensions are largest length and width; parts of room may be smaller. Room area is not always equal to product of length and width.

#### Main Building

##### MAIN FLOOR

4pc Bath: 10'11" x 6'7"  
Bedroom: 7'8" x 10'  
Bedroom: 11'3" x 11'9"  
Bedroom: 11' x 9'5"  
Den: 11'3" x 11'  
Dining: 6'2" x 11'6"  
Kitchen: 11' x 14'9"  
Laundry: 11' x 5'11"  
Living: 17'8" x 11'10"  
Master: 11' x 15'9"

#### Workshop

##### WORKSHOP

Workshop: 18'11" x 14'11"

### Floor Area Information

For explanation of floor area calculations and method of measurement please see <https://youriguide.com/measure/>. All displayed floor areas are rounded to nearest integer. Total area is computed before rounding and may not equal to sum of displayed floor areas.

#### Main Building

##### MAIN FLOOR

Interior Area: 1402 sq ft  
Perimeter Wall Length: 183 ft  
Perimeter Wall Thickness: 7.0 in  
Exterior Area: 1509 sq ft

#### Workshop

##### WORKSHOP

Excluded Area: 282 sq ft  
Perimeter Wall Length: 70 ft  
Perimeter Wall Thickness: 7.0 in  
Exterior Area: 41 sq ft

#### Total Above Grade Floor Area

Main Building Interior: 1402 sq ft  
**Main Building Exterior: 1509 sq ft**

Workshop Excluded: 282 sq ft  
**Workshop Exterior: 41 sq ft**