

# 21 Mandeville Dr, Yellowknife, NT

Main Floor Total Exterior Area 1203 sq ft  
Total Interior Area 1097 sq ft

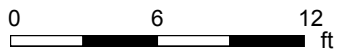

PREPARED: Jul, 2020

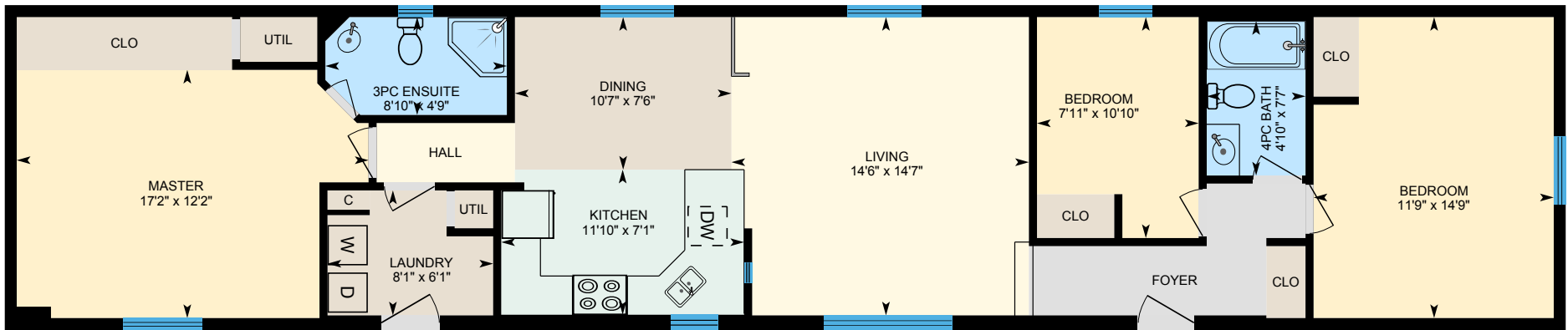

White regions are excluded from total floor area. All room dimensions and floor areas must be considered approximate and are subject to independent verification. For method of measurement please see <https://youriguide.com/measure/>.

# 21 Mandeville Dr, Yellowknife, NT

## Property Details

### Room Measurements

Only major rooms are listed. Some listed rooms may be excluded from total interior floor area (e.g. garage). Room dimensions are largest length and width; parts of room may be smaller. Room area is not always equal to product of length and width.

#### Main Building

##### MAIN FLOOR

3pc Ensuite: 4'9" x 8'10"

4pc Bath: 7'7" x 4'10"

Bedroom: 10'10" x 7'11"

Bedroom: 14'9" x 11'9"

Dining: 7'6" x 10'7"

Kitchen: 7'1" x 11'10"

Laundry: 6'1" x 8'1"

Living: 14'7" x 14'6"

Master: 12'2" x 17'2"

### Floor Area Information

For explanation of floor area calculations and method of measurement please see <https://youriguide.com/measure/>. All displayed floor areas are rounded to nearest integer. Total area is computed before rounding and may not equal to sum of displayed floor areas.

#### Main Building

##### MAIN FLOOR

Interior Area: 1097 sq ft

Perimeter Wall Length: 182 ft

Perimeter Wall Thickness: 7.0 in

Exterior Area: 1203 sq ft

#### Total Above Grade Floor Area

Main Building Interior: 1097 sq ft

**Main Building Exterior: 1203 sq ft**