

Chris Brown

778.881.0673 chris@chrisbrownrealestate.ca
www.chrisbrownrealestate.ca

**633 Victoria Drive,
Vancouver**

3 bedrooms + 2 1/2 bathrooms

Level Two - 486 sq.ft.
Ceiling height - 9' 0"



Level One - 455 sq.ft.
Ceiling height - 9' 0"



stilhavn
REAL ESTATE SERVICES

www.OPTIMUMFLOORPLANS.com

4K Matterport Tours

2D & 3D Floor Plans

604-729-5033

OPTIMUM
FLOOR PLAN DESIGNS

Floor plan measurements, dimensions, square footage, existing structures & features are approximations and for illustrative purposes only. We make no guarantee, warranty, or representation, expressed or implied, as to the accuracy and completeness of this rendering. Independent verification is recommended. E&O Insured for \$1,000,000

Chris Brown

778.881.0673 chris@chrisbrownrealestate.ca
www.chrisbrownrealestate.ca

633 Victoria Drive, Vancouver

3 bedrooms + 2 1/2 bathrooms

Level One: 455 sq.ft.
Level Two: 486 sq.ft.
Level Three: 475 sq.ft.
Total Interior: 1,416 sq.ft.

Exterior Living: 541 sq.ft.

Rooftop Deck - 412 sq.ft.

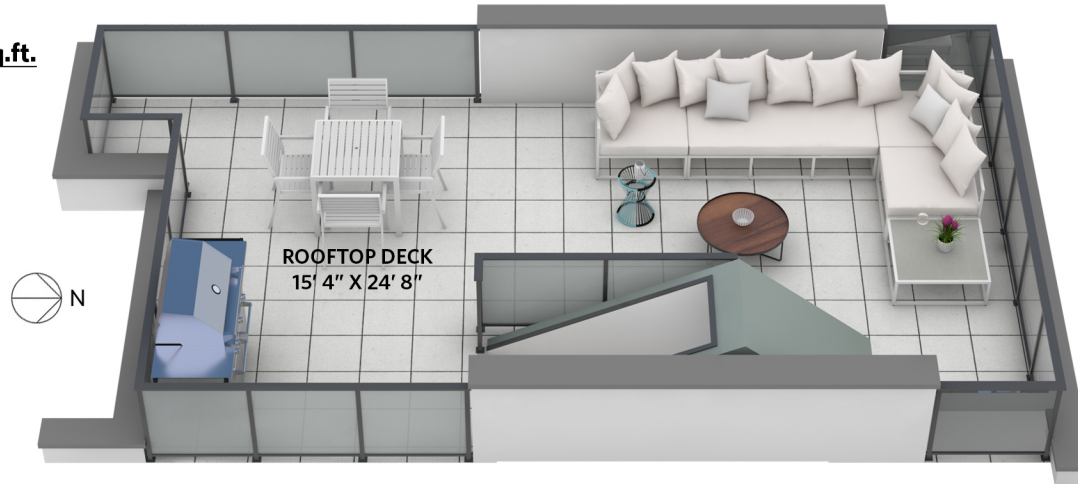

Level Three - 475 sq.ft.
Ceiling height - 9' 0"

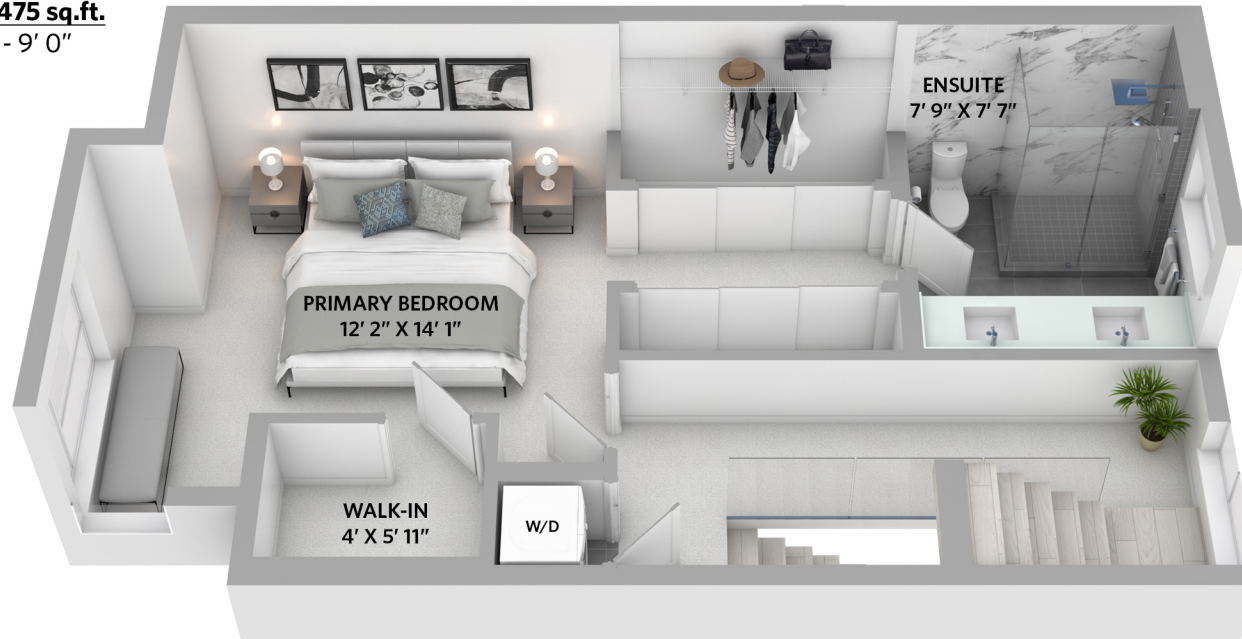

stilhavn
REAL ESTATE SERVICES

www.OPTIMUMFLOORPLANS.com

4K Matterport Tours

2D & 3D Floor Plans 604-729-5033

OPTIMUM
FLOOR PLAN DESIGNS

Floor plan measurements, dimensions, square footage, existing structures & features are approximations and for illustrative purposes only. We make no guarantee, warranty, or representation, expressed or implied, as to the accuracy and completeness of this rendering. Independent verification is recommended. E&O Insured for \$1,000,000