

# Chris Brown

778.881.0673   chris@chrisbrownrealestate.ca  
www.chrisbrownrealestate.ca

## 633 Victoria Drive, Vancouver

3 bedrooms + 2 1/2 bathrooms

Level One:            455 sq.ft.  
Level Two:           486 sq.ft.  
Level Three:          475 sq.ft.  
**Total Interior:    1,416 sq.ft.**

Exterior Living:      541 sq.ft.

**Rooftop Deck - 412 sq.ft.**

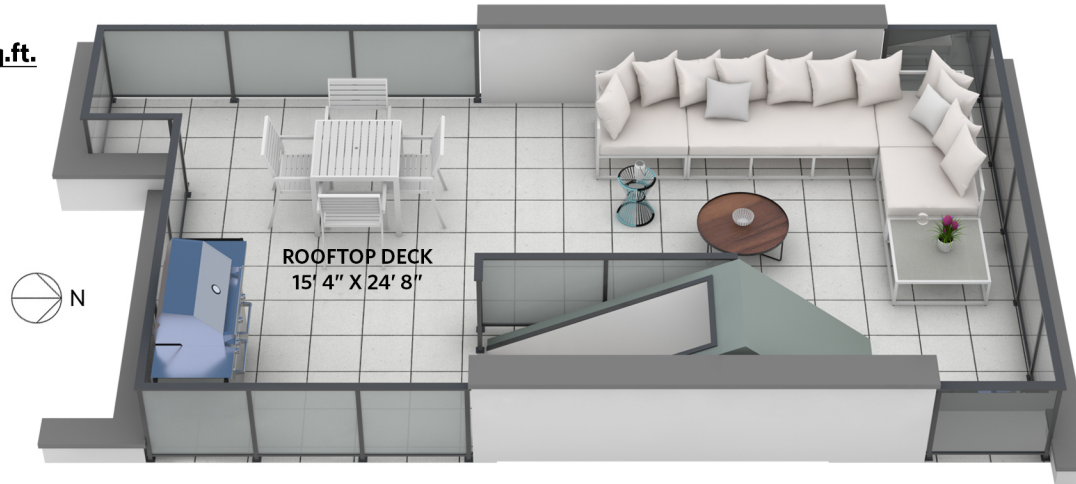

**Level Three - 475 sq.ft.**  
Ceiling height - 9' 0"

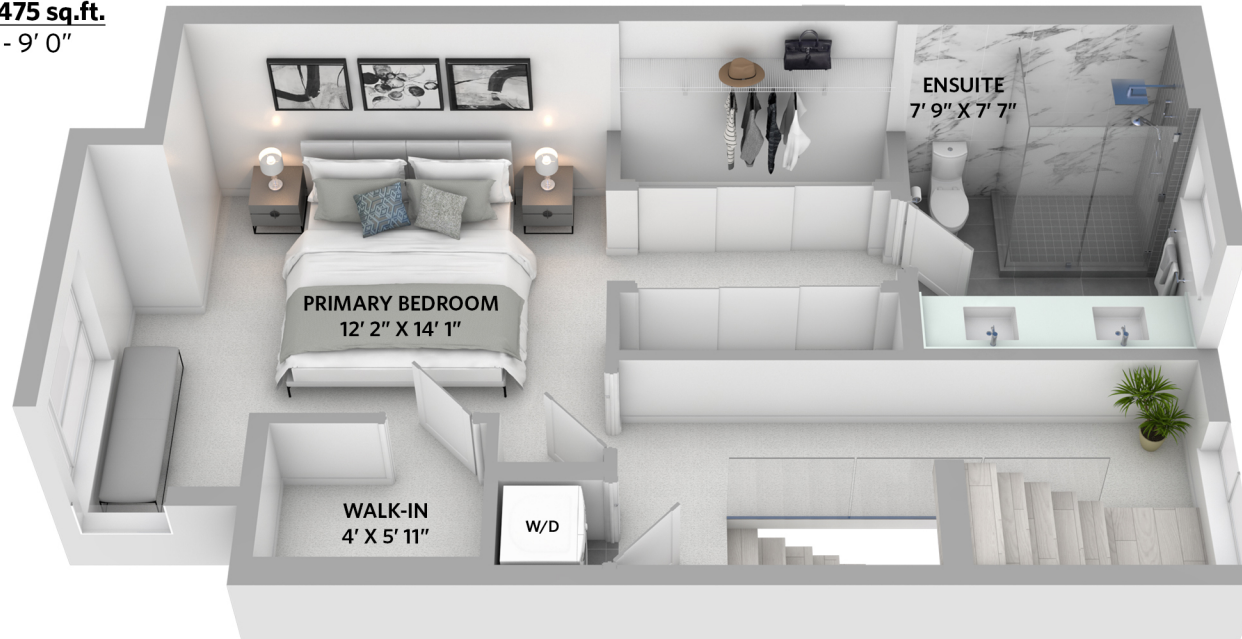

**stilhavn**  
REAL ESTATE SERVICES

[www.OPTIMUMFLOORPLANS.com](http://www.OPTIMUMFLOORPLANS.com)

4K Matterport Tours

2D & 3D Floor Plans   604-729-5033

**OPTIMUM**  
FLOOR PLAN DESIGNS

Floor plan measurements, dimensions, square footage, existing structures & features are approximations and for illustrative purposes only. We make no guarantee, warranty, or representation, expressed or implied, as to the accuracy and completeness of this rendering. Independent verification is recommended. E&O Insured for \$1,000,000