

BLOCK 178
0.30 RESERVE
PART 11, PLAN 20R-15062

TUESMAN WAY
DEDICATED BY REGISTERED PLAN 20M-846

HERTFORDSHIRE WAY
DEDICATED BY REGISTERED PLAN 20M-846

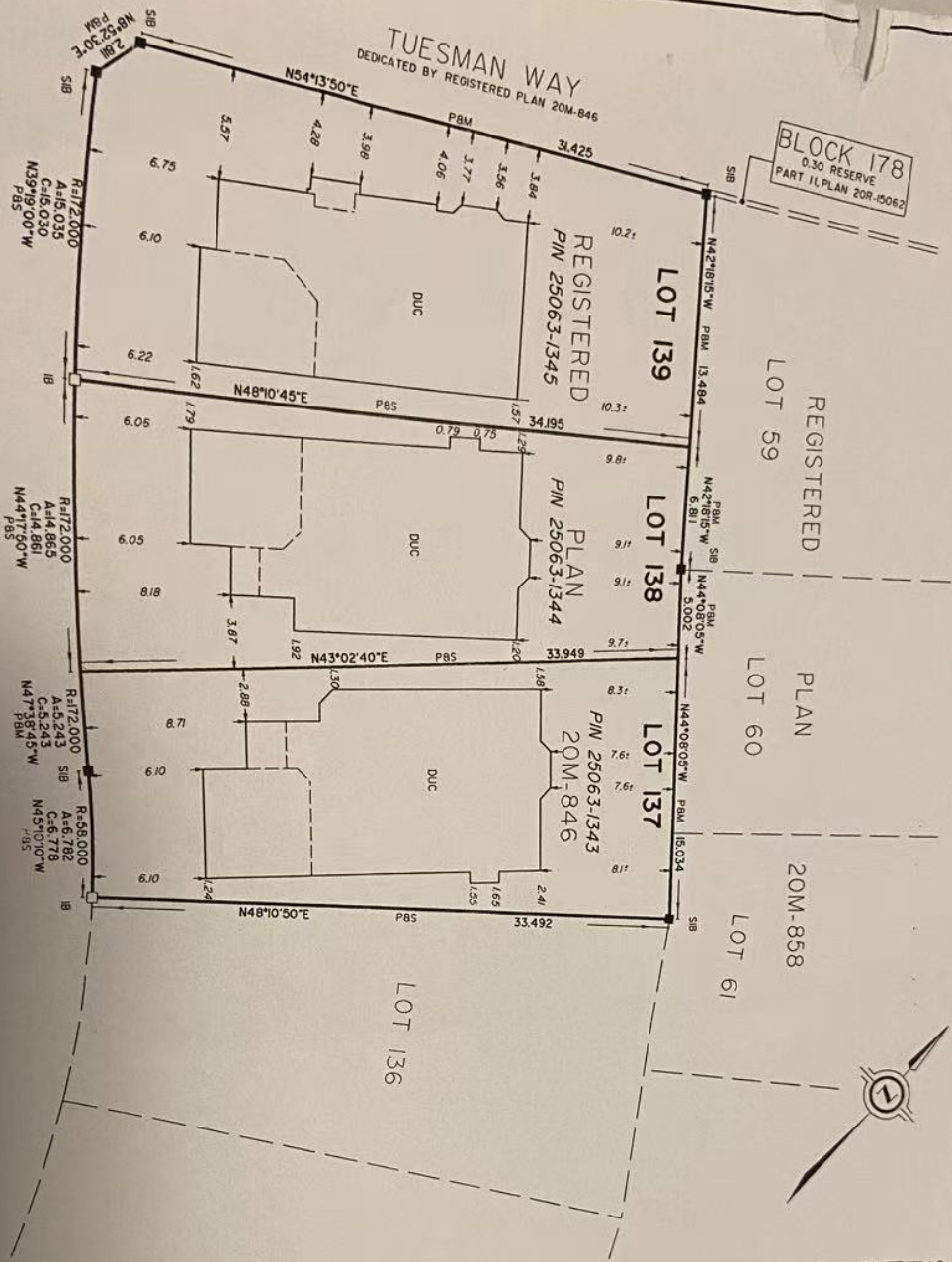

SURVEYOR'S REAL PROPERTY REPORT
PART 1 - PLAN SHOWING
LOTS 137, 138 AND 139
REGISTERED PLAN 20M-846
TOWN OF OAKVILLE
REGIONAL MUNICIPALITY OF HALTON
SCALE 1:250
J. D. BARNES LIMITED
© COPYRIGHT-2003

METRIC
DISTANCES SHOWN ON THIS PLAN ARE IN METRES AND CAN BE CONVERTED TO FEET BY DIVIDING BY 0.3048.

PART 2 - SURVEY REPORT

- DESCRIPTION
LOTS 137, 138 AND 139 - REGISTERED PLAN 20M-846
- REGISTERED EASEMENTS AND/OR RIGHTS-OF-WAY
- NONE RECORDED
- ADDITIONAL REMARKS
PLAN PREPARED FOR FERNBROOK HOMES

NOTES

BEARINGS ARE ASTRONOMIC AND REFERRED TO THE SOUTHEASTERN LIMIT OF TUESMAN WAY HAVING A BEARING OF N54°13'50"E AS SHOWN ON REGISTERED PLAN 20M-846.
☒ DENOTES SURVEY MONUMENT FOUND
☐ DENOTES SURVEY MONUMENT SET
☐ DENOTES STANDARD IRON BAR
☐ DENOTES IRON ROD
☐ DENOTES DWELLING UNDER CONSTRUCTION
☐ DENOTES REGISTERED PLAN 20M-846 AND SET
☐ DENOTES REGISTERED PLAN 20M-846 AND MEASURED
☐ DENOTES PBM
 ALL BUILDING TIES ARE TAKEN TO CONCRETE FOUNDATION
 ALL FOUND SURVEY MONUMENTS SET BY ANTON KIKAS LIMITED UNLESS NOTED OTHERWISE.

SURVEYOR'S CERTIFICATE

I CERTIFY THAT:
 1. THIS SURVEY AND PLAN ARE CORRECT AND IN ACCORDANCE WITH THE SURVEY ACT, THE SURVEYORS ACT AND THE LAND TITLES ACT AND THE REGULATIONS MADE UNDER THEM.
 2. THE SURVEY WAS COMPLETED ON THE 26th DAY OF JUNE, 2003.

DATE *Sept 4/03*
[Signature]
 S. J. BARNES
 ONTARIO LAND SURVEYOR

ONTARIO LAND SURVEYOR

J. D. BARNES LIMITED
 461 WINTERLATOR WAY, SUITE A, HALTON, ONT. L9T 1K1
 T: (905) 875-9933 F: (905) 875-9934 www.jdbarnes.com
 03-29-971-00-137

ASSOCIATION OF ONTARIO LAND SURVEYORS
 PLAN SUBMISSION FORM
1473416
 THIS PLAN IS NOT VALID UNLESS IT IS AN EMBOSSED ORIGINAL COPY OR ISSUED BY THE SURVEYOR IN ACCORDANCE WITH Regulation 1126, Section 29(3).