

**239 28th Street East,
North Vancouver, B.C.**

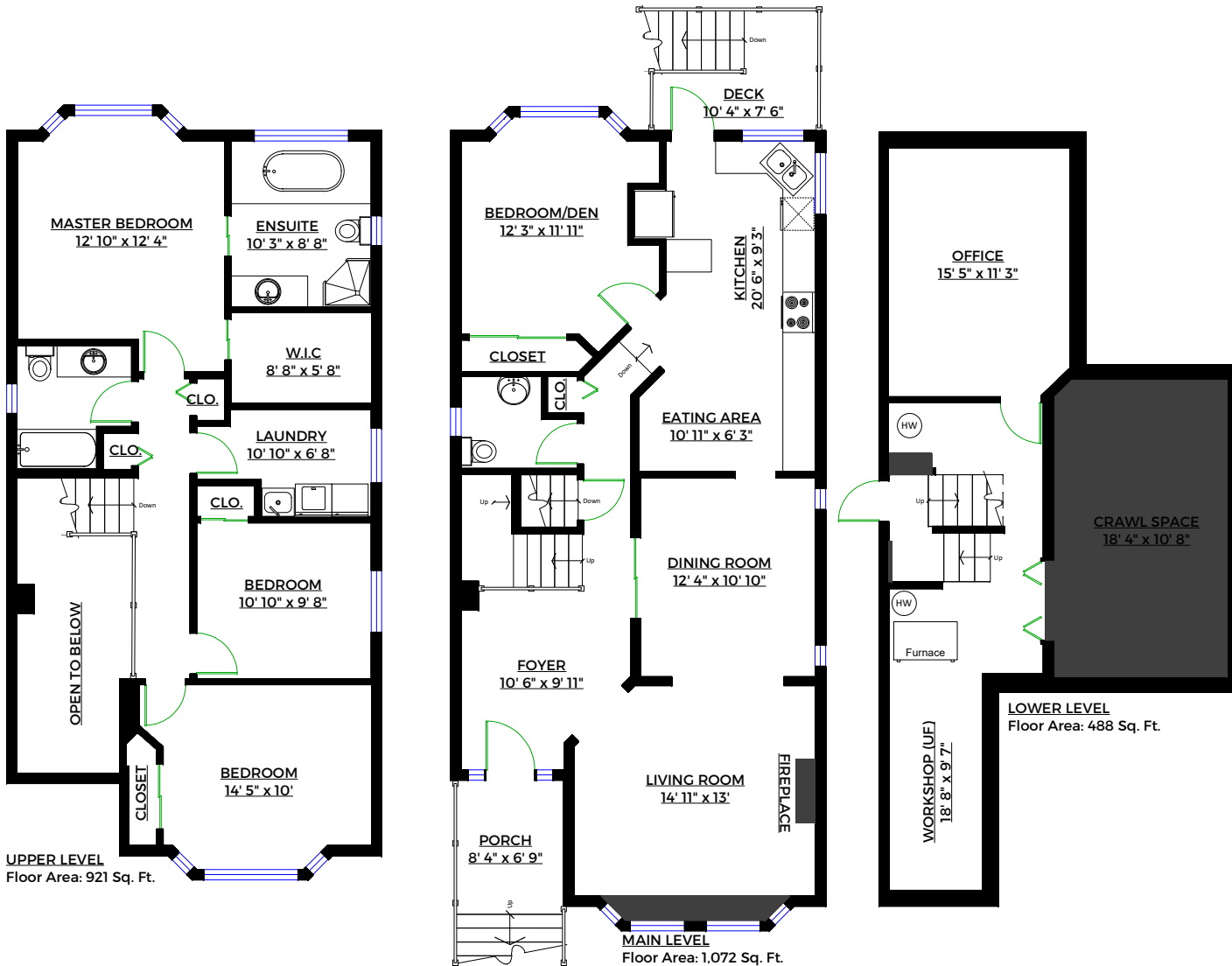

Totals**

Main Level:	1,072 sq. ft.
Upper Level:	921 sq. ft.
Lower Level:	488 sq. ft.
Total (FIN):	2,481 sq. ft.
Unfinished:	18 sq. ft.
Crawl Space:	233 sq. ft.
Grand Total:	2,732 sq. ft.

Porch:	56 sq. ft.
Deck:	56 sq. ft.
Total:	112 sq. ft.

** Approx. based on interior measurements to exterior walls
** Total square footage not taken from original blueprints

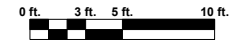

ROYAL LEPAGE

Gavin Hughes
604.626.6618