

3370 Craigend, West Vancouver

4 bedrooms + office + 4 1/2 bathrooms

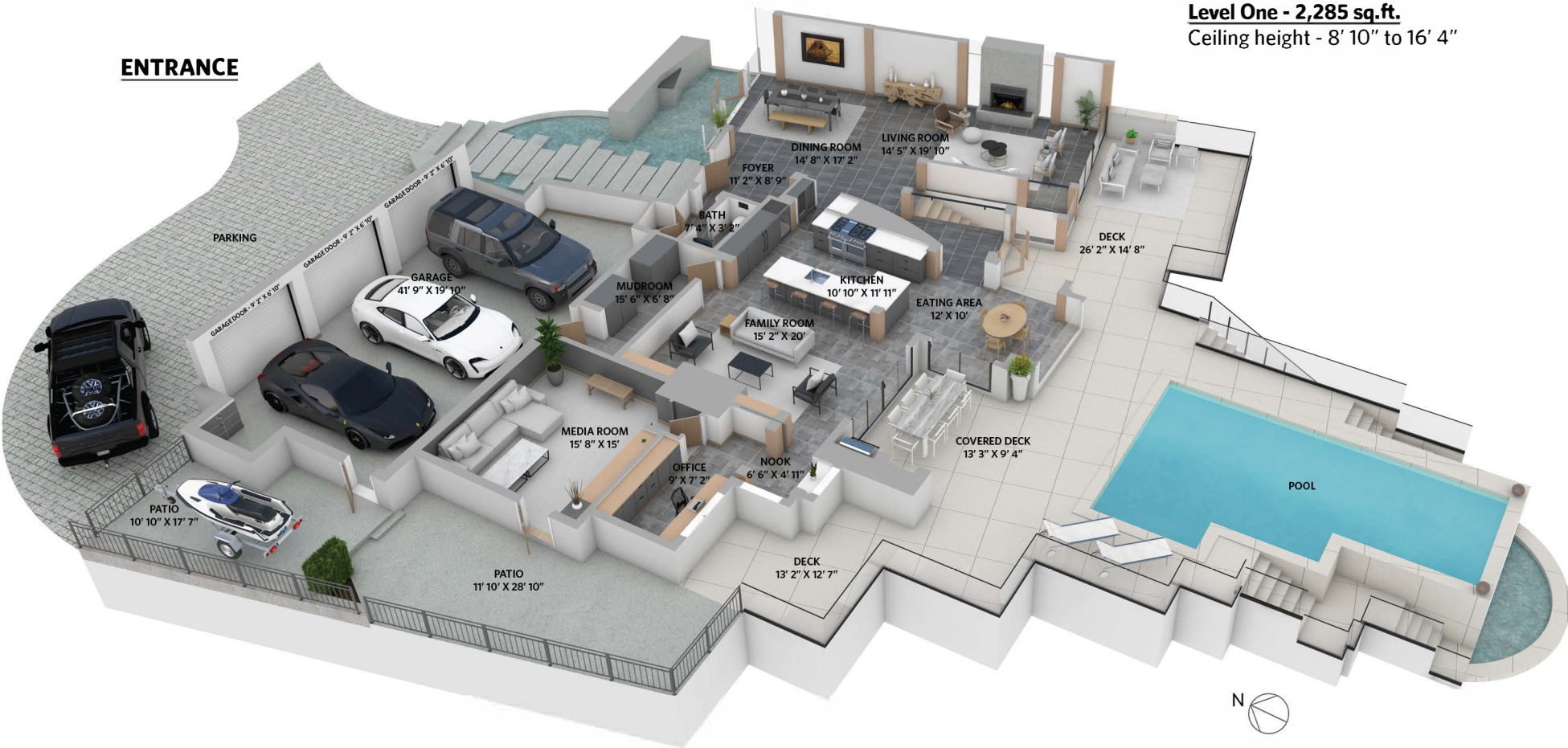

Level One - 2,285 sq.ft.
Ceiling height - 8' 10" to 16' 4"

Jamie MacDougall, PREC
604.992.2282
jamie.macdougall@evcanada.com
jamiemacdougall.com

Polly Reitze, PREC
60.671.7076
polly@pollyreitze.com
pollyreitze.com

Level Two - 1,315 sq.ft.
Ceiling height - 9' 0"



Jamie MacDougall, PREC
604.992.2282
jamie.macdougall@evcanada.com
jamiemacdougall.com

Polly Reitze, PREC
60.671.7076
polly@pollyreitze.com
pollyreitze.com

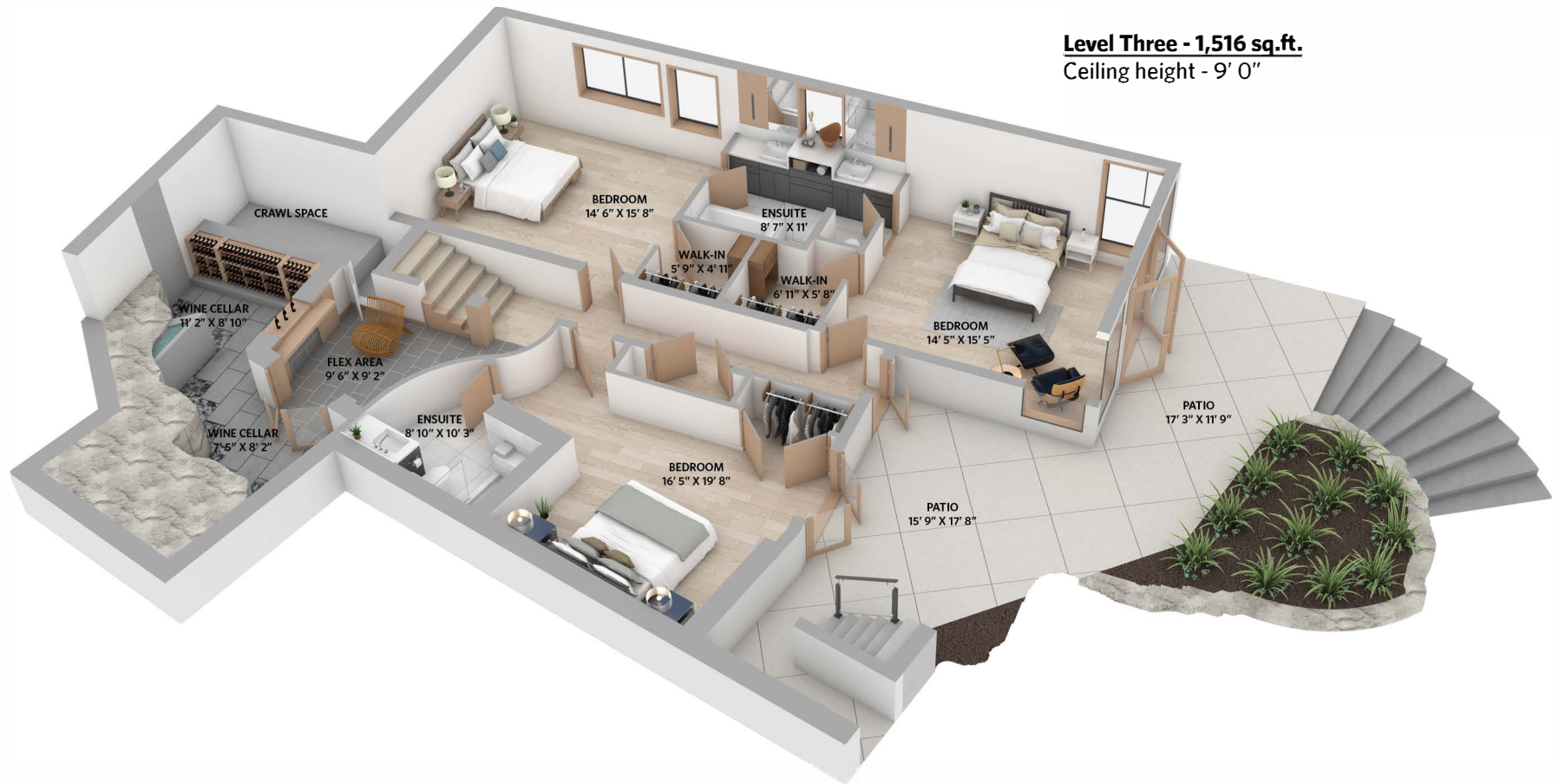

Level Three - 1,516 sq.ft.

Ceiling height - 9' 0"

Level One: 2,285 sq.ft.
 Level Two: 1,315 sq.ft.
 Level Three: 1,516 sq.ft.
Total Interior: 5,116 sq.ft.

Garage: 773 sq.ft.
 Exterior Living: 2,672 sq.ft.
 Exterior Bath: 101 sq.ft.
 Pump House: 40 sq.ft.
 Crawl Space: 1,536 sq.ft.

Jamie MacDougall, PREC
 604.992.2282
 jamie.macdougall@evcanada.com
 jamiemacdougall.com

Polly Reitze, PREC
 60.671.7076
 polly@pollyreitze.com
 pollyreitze.com