

11 Belton Road

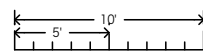

Measurements and Calculations are approximate
To be used as guidelines only
www.measuredup.ca

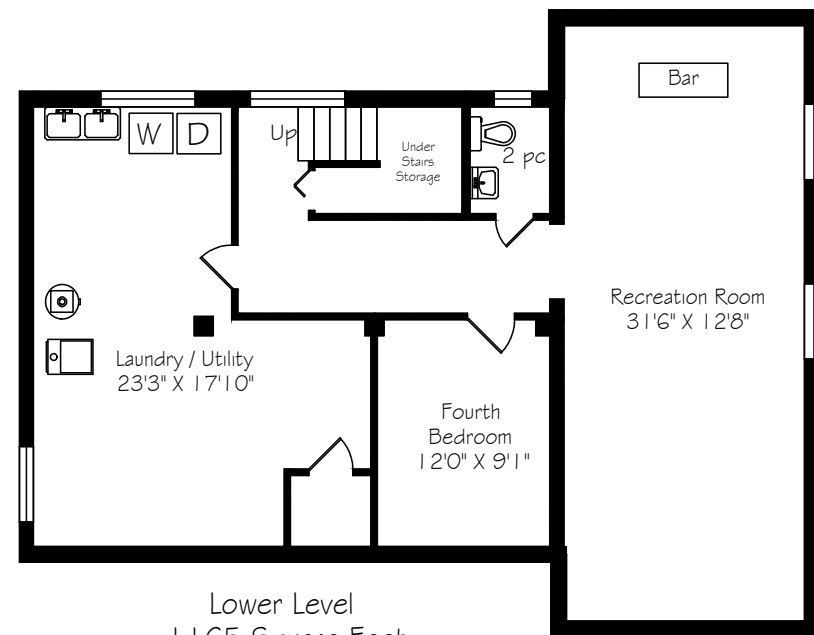

LOT SIZE: 57.59 x 111.3 ft.

BEDROOMS: 3

POSSESSION: Immediate/TBA

TAXES: \$5,069.87/2018

BATHROOMS: 1x4, 1x2

PARKING: Single carport & 2 car parking

ROYAL LEPAGE Signature Realty
IND. OWNED & OPERATED BROKERAGE

Karen
MOLLARTEAM
BROKER

EXCEEDING YOUR EXPECTATIONS

416.443.0300 • karenmillarteam.com • karen@karenmillar.com



Prospective purchasers should satisfy themselves as the accuracy of the information contained in this feature sheet. All measurements are approximate. The statements contained herein are based on sources which we believe are reliable, but for which we assume no responsibility.

11 Belton Road





EXTERIOR

- Single carport
- Two car parking
- Garden shed
- Wooden ramp
- Mature trees

VESTIBULE

- Wall-to-wall windows
- Broadloom

FOYER

- Hardwood flooring under broadloom
- Sliding double door coat closet

MAIN FLOOR

- Hardwood flooring under broadloom
- Linen closet
- Walk-out to garden

LIVING ROOM

- Open concept
- Cathedral ceiling
- Hardwood flooring under broadloom
- Large picture window
- Overlooks front garden

DINING ROOM

- Hardwood flooring under broadloom
- Overlooks back garden

KITCHEN

- Eat-in area
- Overlooks back garden
- Kenmore fridge
- Moffat stove
- Built-in pantry

MASTER BEDROOM

- Hardwood flooring under broadloom
- His & her sliding double door closets
- Overlooks front garden

BEDROOM

- Hardwood flooring under broadloom
- Overlooks garden

BEDROOM

- Hardwood flooring under broadloom
- Overlooks garden

4 PIECE BATHROOM

LOWER LEVEL

- Storage under the stairs
- Access to large walk-in storage room

RECREATION/GAMES ROOM

- Two above-ground windows
- Built-in Dry Bar
- Storage cupboards

2 PIECE POWDER ROOM

LAUNDRY/UTILITY ROOM

- Beaumark washing machines
- Kenmore dryer
- Kenmore deep freezer
- Two above-ground windows
- Lennox furnace '14
- Large walk-in storage closet
- Central air conditioner '14

