

# FLOOR PLAN

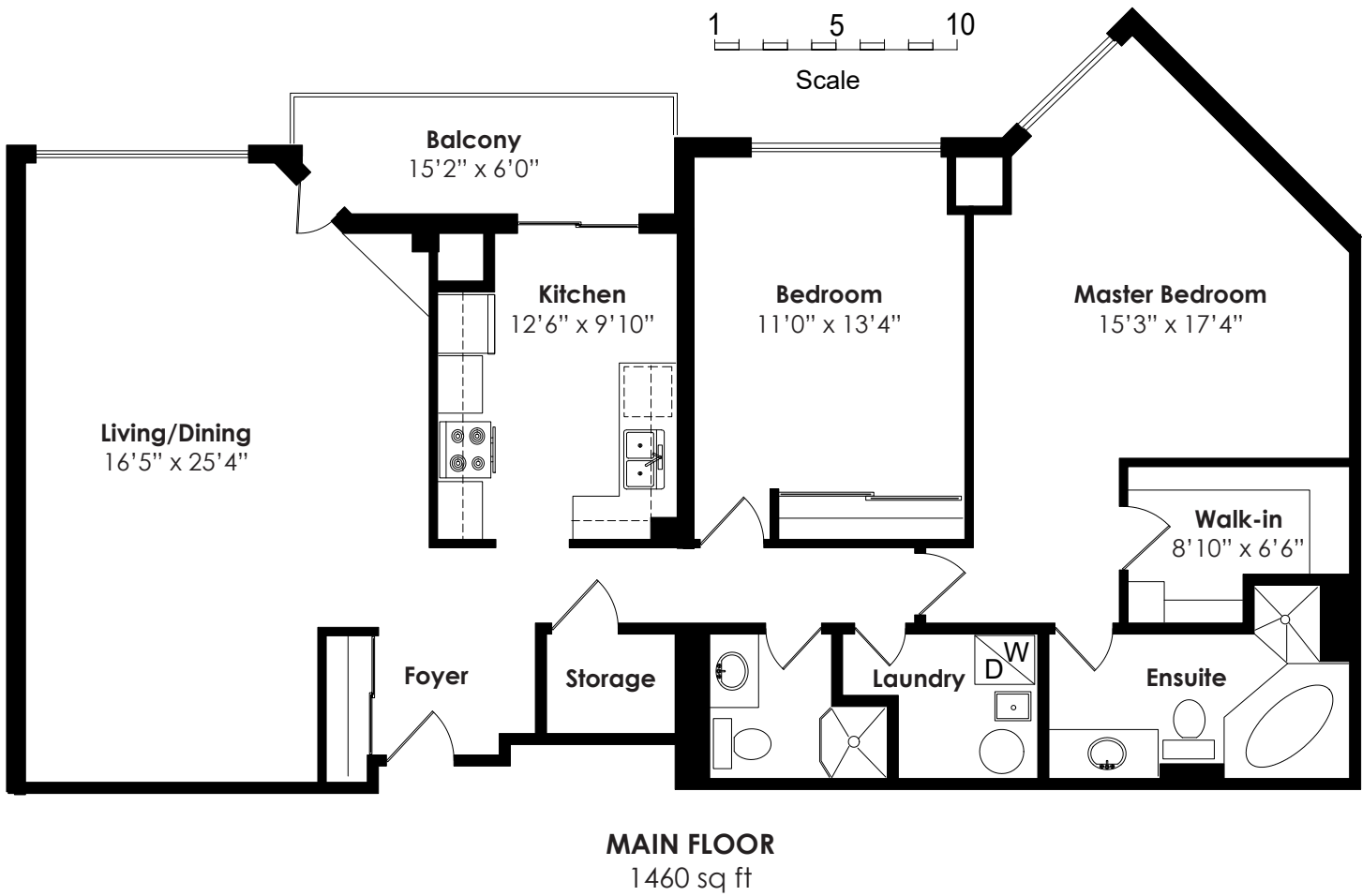

**TAXES:** \$2,923.33/2018  
**PARKING:** 1 car parking (P3-015)

**BEDROOMS:** 2  
**LOCKER:** C-135

**BATHROOMS:** 1x4, 1x3  
**POSSESSION:** Immediate/tba

**MAINTENANCE FEE:**  
\$1,132.21/month  
(includes: water, parking, common elements & building insurance)



Signature Realty  
IND. OWNED & OPERATED BROKERAGE

Karen  
**MOLLARTEAM**  
BROKER

EXCEEDING YOUR EXPECTATIONS

416.443.0300 • karenmillarteam.com • karen@karenmillar.com



Prospective purchasers should satisfy themselves as the accuracy of the information contained in this feature sheet. All measurements are approximate. The statements contained herein are based on sources which we believe are reliable, but for which we assume no responsibility.

# 18 CONCORDE PLACE

## SUITE 310







**FOYER**

- Ceramic tile flooring
- Sliding mirrored double closet

**HALLWAY**

- Broadloom
- Access to large walk-in closet
- Access to Laundry Room
  - Stacked Whirlpool washer & dryer

**LIVING/DINING ROOM**

- Open concept
- Gas fireplace
- Overlooks ravine
- Terrace door walk-out to balcony
- Broadloom

**KITCHEN**

- Breakfast nook
- Ceramic tile flooring
- Sliding door walk-out to balcony
- Ceramic tile backsplash
- Overlooks ravine
- Frigidaire fridge
- Built-in Whirlpool microwave
- Kenmore stove
- Built-in Kenmore dishwasher

**MASTER BEDROOM**

- Broadloom
- Overlooks ravine & courtyard
- Sliding door to Juliette balcony
- Large walk-in closet
  - Built-in organizers

**4 PIECE ENSUITE BATHROOM**

- Ceramic tile floor flooring & surround
- Large 2 person jet tub
- Pot lights
- Walk-in shower

**BEDROOM**

- Broadloom
- Floor-to-ceiling sliding double closet
- Overlooks ravine

**3 PIECE BATHROOM**

- Ceramic tile flooring & surround
- Pot lights
- Built-in storage cabinet

**AMENITIES**

- Barbecue's allowed
- Car wash
- Concierge & security guard
- Tennis court
- Visitor parking
- Exercise room
- Games room
- Indoor pool & hot tub
- Party/meeting room
- Rooftop deck & garden
- Billiards room
- Guest suites

