

1638 Matthews Avenue,
Vancouver, B.C.

Main Floor:	1,253 sq.ft.
Upper Floor:	488 sq.ft.
Total:	1,741 sq.ft.
Restr. Headroom:	21 sq.ft.

Auxiliary Area

Balconies:	381 sq.ft.
------------	------------

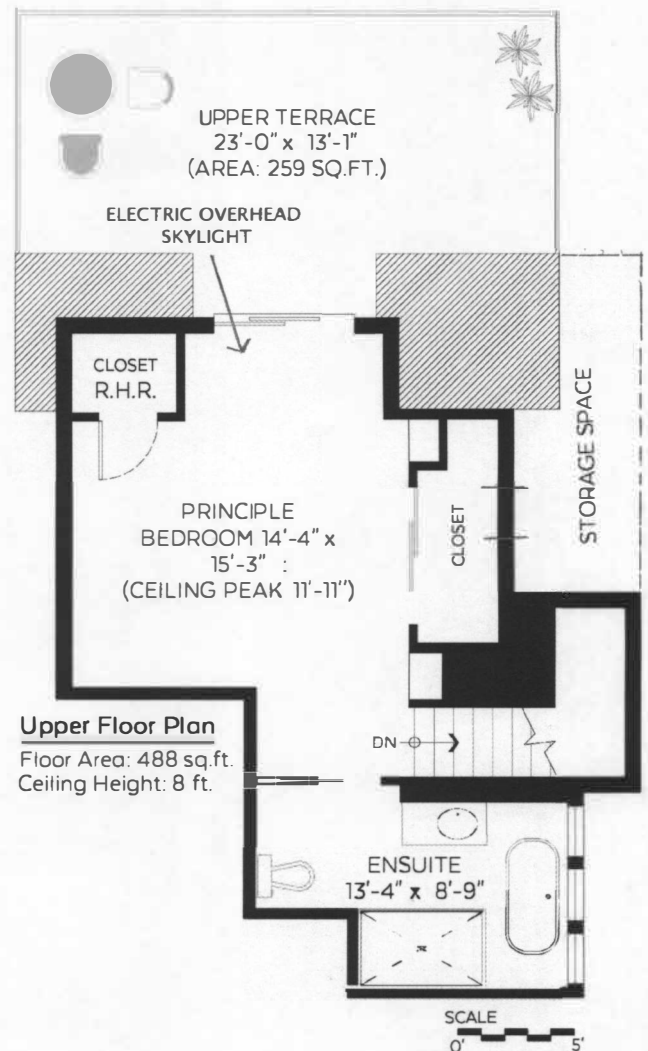

Valid Until: May 8, 2023

The floor plan is not suitable for architectural/construction and is covered under E&O. © Excelsior Measuring Inc. 2022. All rights reserved for Excelsior Measuring Inc. Users shall not publish and distribute such material (in whole or in part) and/or incorporate it in other works in any form.

