

MAIN FLOOR

724 SQ. FT.

7'11" CEILING

UPPER FLOOR

676 SQ. FT.

8'0" CEILING

LOWER FLOOR

609 SQ. FT.

7'10" CEILING

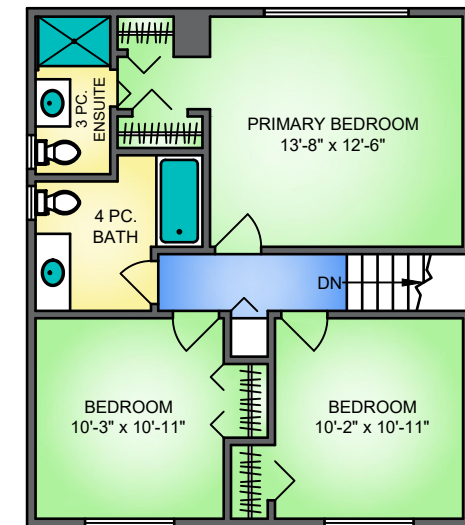

NORTH

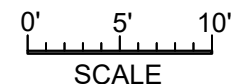

9 SYMMES BAY, PORT MOODY

JUNE 3, 2025

PREPARED BY PROPER MEASURE.
FOR THE EXCLUSIVE USE OF ELLIOT MANDEL CORN.
PLANS MAY NOT BE 100% ACCURATE, IF CRITICAL BUYER TO VERIFY E&O INSURED.

FLOOR	AREA (SQ. FT.)		
	FINISHED	GARAGE	DECK / PATIO
MAIN	724	-	529
UPPER	676	-	-
LOWER	609	578	201
TOTAL	2009	578	730