

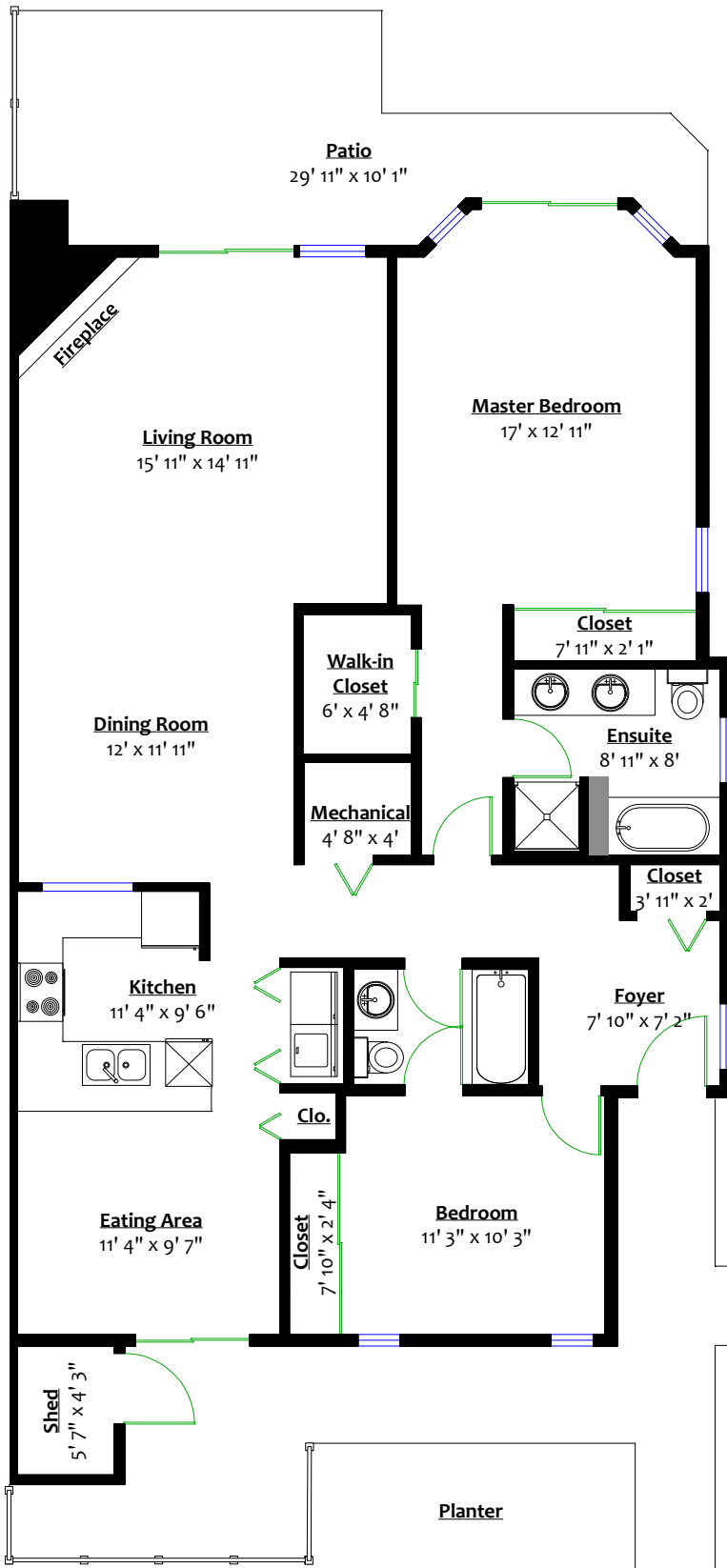

1605 Augusta Avenue, Burnaby, B.C.

Totals**

Main Level:	1,424 sq. ft.
Shed:	29 sq. ft.
Patio:	216 sq. ft.
Carport:	357 sq. ft.
Total:	602 sq. ft.



MAIN LEVEL
Floor Area: 1,424 Sq. Ft.

