

LOWER FLOOR
681 SQ. FT.
11'-10" SLOPED CEILING

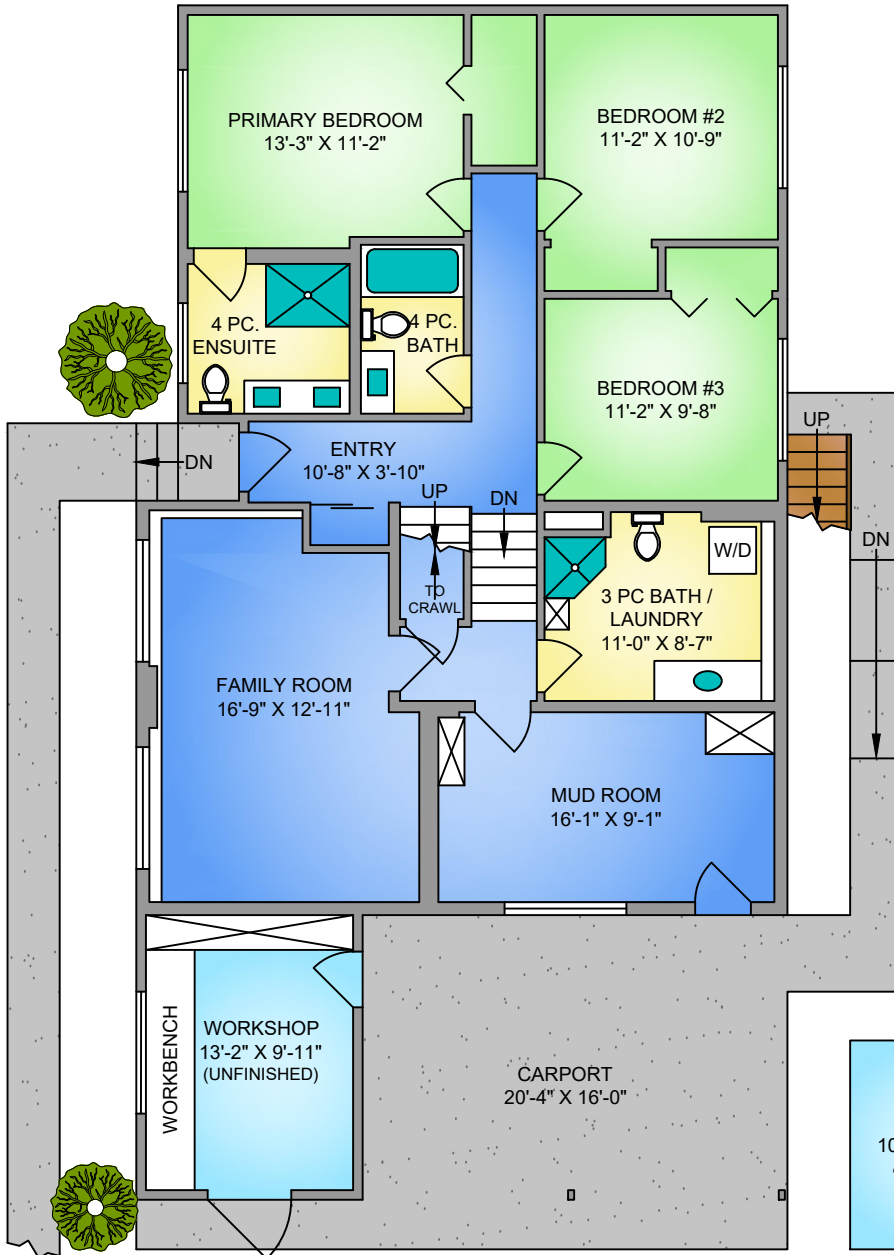

WORKSHOP
148 SQ. FT.

BOTTOM FLOOR
618 SQ. FT.
8'-0" CEILING

MAIN FLOOR
618 SQ. FT.
9'-0" VAULTED CEILING

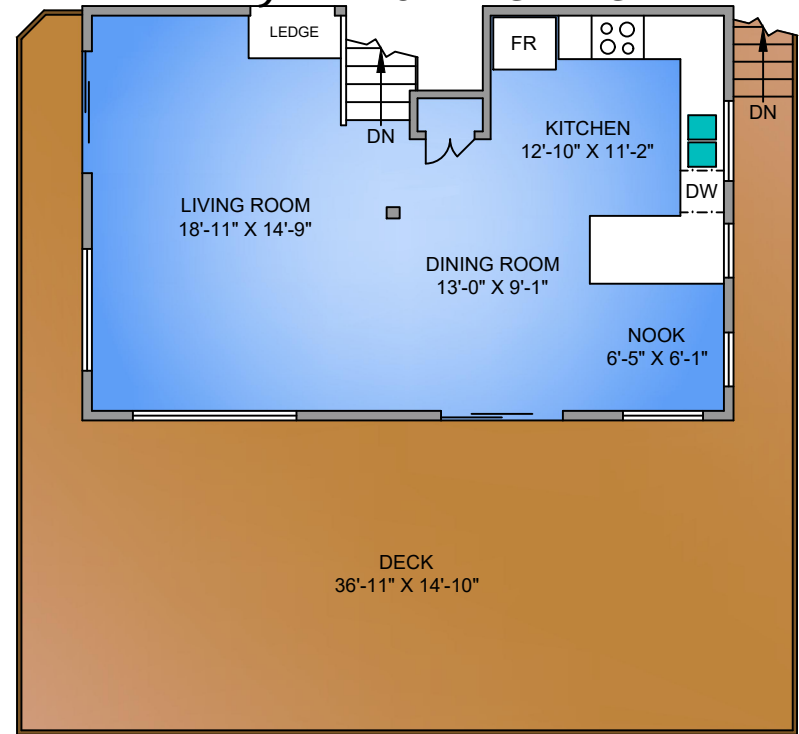

SHED
 10'-0" X 6'-0"
 60 SQ. FT.

SHED
 10'-0" X 8'-0"
 80 SQ. FT.

NORTH

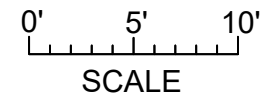

1805 DEERBOURNE PLACE
 APRIL 8, 2026

This floor plan has been laser measured and drafted by a professional Drafting Technician using AutoCAD software. ANSI Z765-2021 Method for Single-Family Residential Buildings used in calculating Area. Private resale or modification of this copyrighted document to a third party by any individual or entity, other than the original creator is strictly prohibited. Plans may not be 100% accurate. Buyer must verify any critical measurement.

FLOOR	AREA (SQ. FT.)		
	FINISHED	UNFINISHED	DECK / PATIO
MAIN	618	-	548
LOWER	681	-	-
BOTTOM	618	-	-
TOTAL	1917	-	548
WORKSHOP	-	148	-