

**LOWER FLOOR**  
**1176 SQ. FT.**  
**7'-10" CEILING**

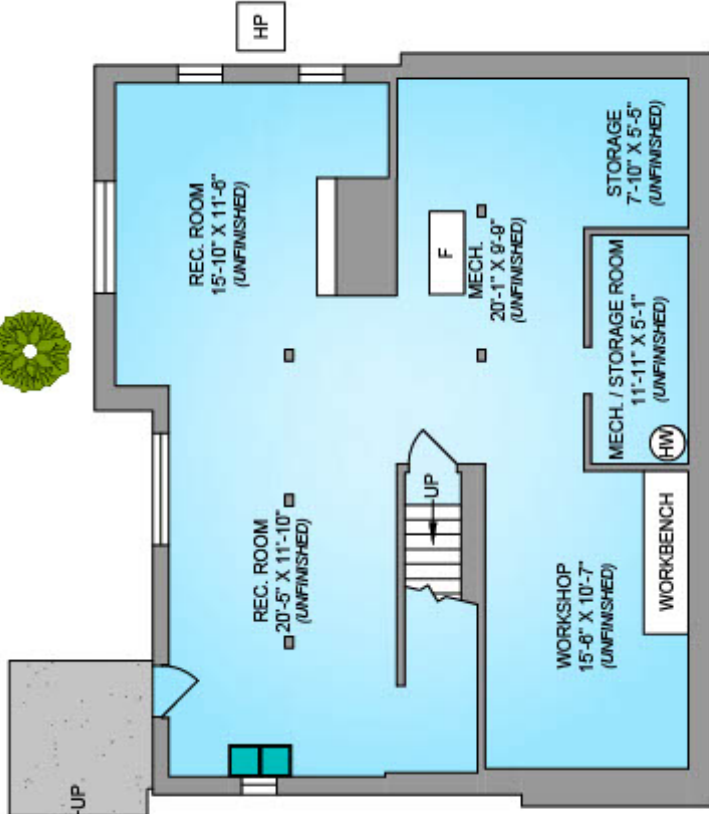

NORTH

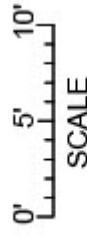

**MAIN FLOOR**  
**1181 SQ. FT.**  
**10'-11" VAULTED CEILING**



**1518 HAIDA WAY**

JUNE 5, 2026

This floor plan has been laser measured and drafted by a professional Drafting Technician using AutoCAD software. ANSI Z765-2021 Method for Single-Family Residential Buildings used in calculating Area. Private resale or modification of this copyrighted document to a third party by any individual or entity, other than the original creator is strictly prohibited. Plans may not be 100% accurate. Buyer must verify any critical measurement.

FLOOR	AREA (SQ. FT.)	
	FINISHED	UNFINISHED
MAIN	1181	-
LOWER	-	1176
TOTAL	1181	1176
GARAGE	-	245
		DECK / PATIO
		162
		83
		245