

# BAYSIDE TOWNS

ON FIFTH

BLOCK A - UNIT 4  
1,748 sq. ft. - 3 Bed 4 Bath

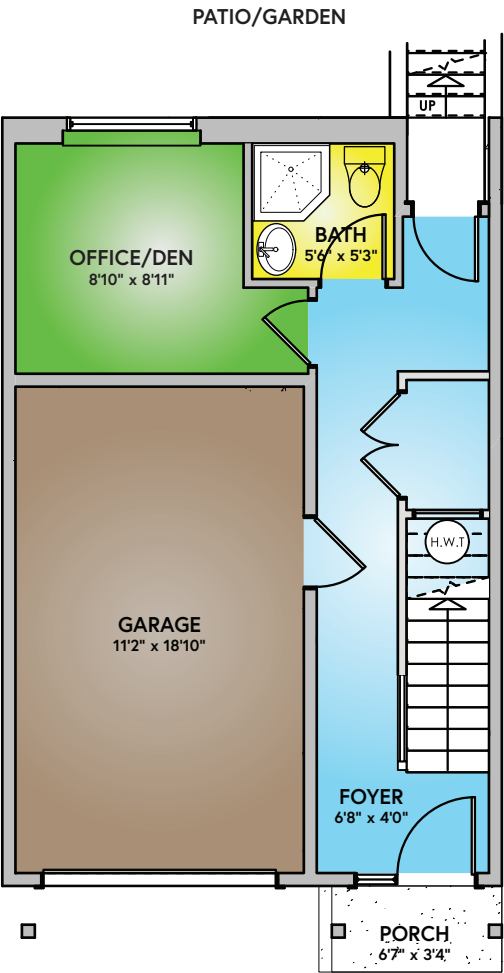

LOWER FLOOR  
(559 sq. ft.)

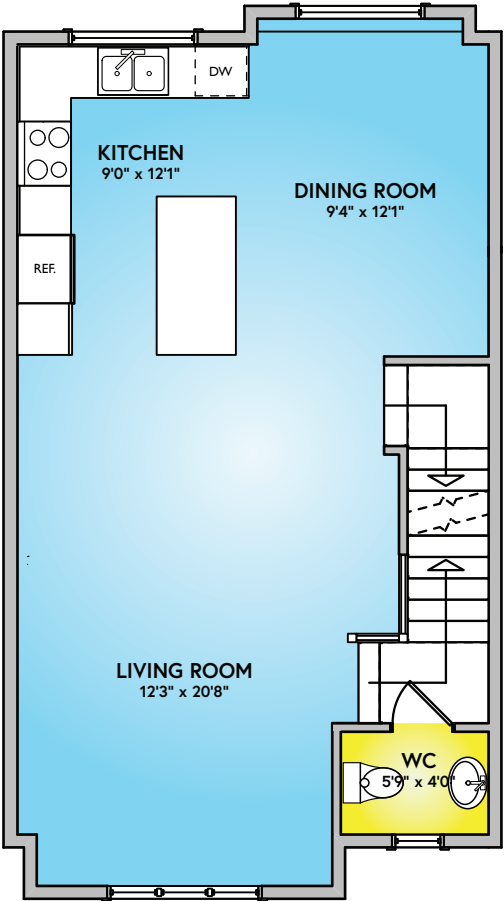

MAIN FLOOR  
(589sq. ft.)

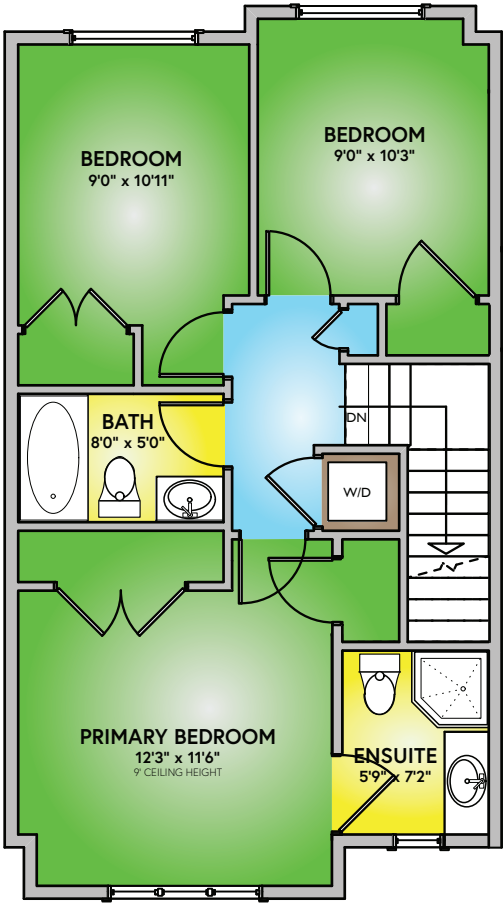

UPPER FLOOR  
(600 sq. ft.)

WHILST EVERY ATTEMPT HAS BEEN MADE TO ENSURE THE ACCURACY OF THE FLOOR PLAN CONTAINED HERE, MEASUREMENTS OF DOORS, WINDOWS, ROOMS AND ANY OTHER ITEMS ARE APPROXIMATE AND NO RESPONSIBILITY IS TAKEN FOR ANY ERROR AND/OR OMISSION. MEASUREMENTS PRESENTED HEREIN ARE TAKEN FROM THE DEVELOPMENT PERMIT AND ARE NOT AS BUILT. ALL INFORMATION IS APPROXIMATE AND SUBJECT TO CHANGE.