

306 - 2307 RANGER LANE,
PORT COQUITLAM, BC

900 SQ. FT.
9'11"-9'0" CEILING

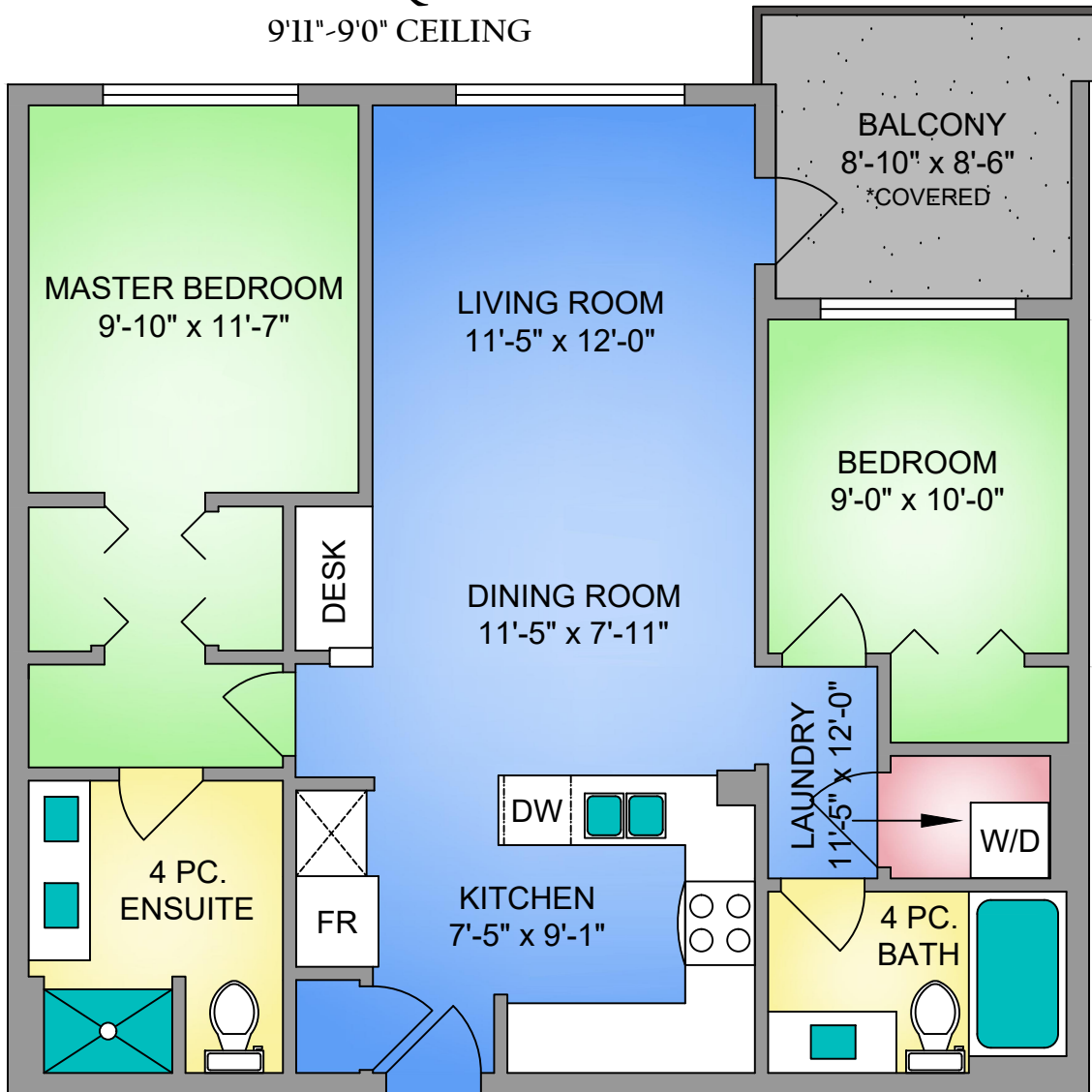

SIGRID WILCOX
PERSONAL REAL ESTATE CORPORATION



NORTH

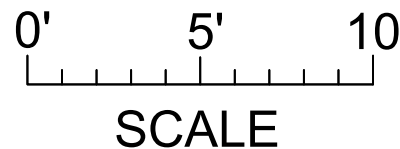

306-2307 RANGER LANE, PORT COQUITLAM NOVEMBER 29, 2017 PREPARED BY PROPER MEASURE - MR. FOR THE EXCLUSIVE USE OF SIGRID WILCOX. PLANS MAY NOT BE 100% ACCURATE, IF CRITICAL BUYER TO VERIFY.		
FLOOR	AREA (SQ. FT.)	
	FINISHED	BALCONY
TOTAL	900	78
NOTES	9'11"-9'0" CEILING	